

HARDWIRING INSTRUCTIONS-240V

WALL WIRE

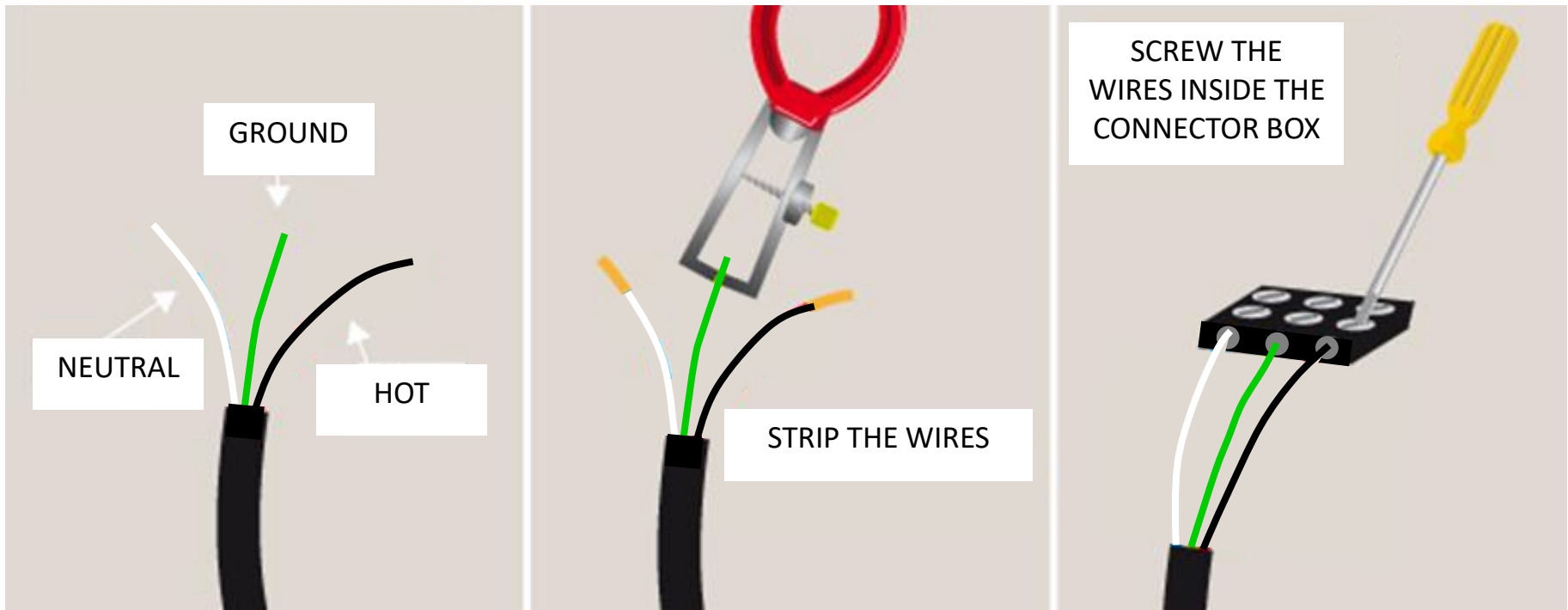

HARDWIRING INSTRUCTIONS

GLASS HEATER WIRE

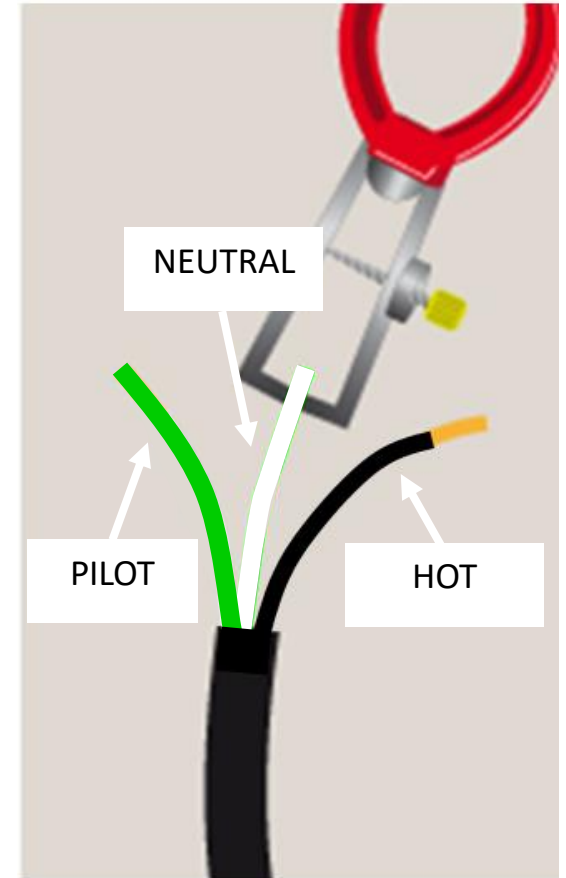
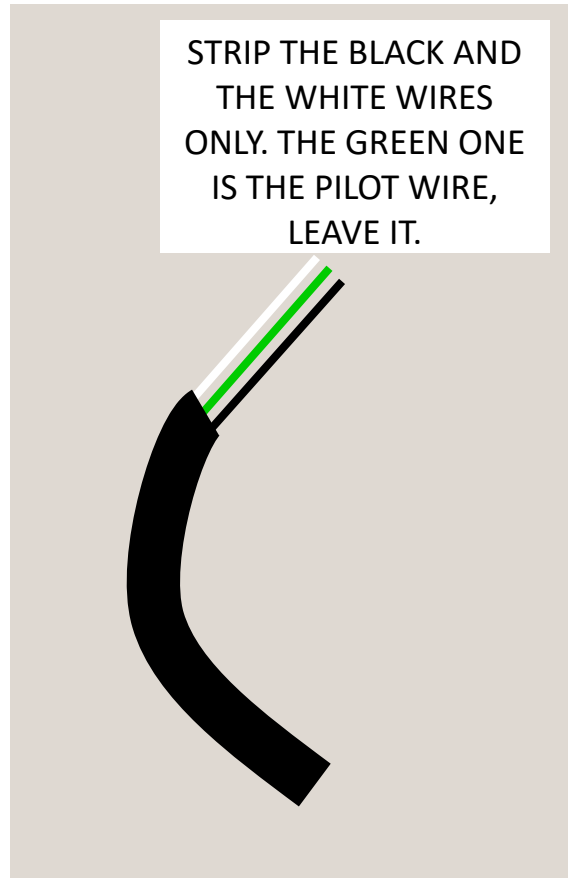

HARDWIRING INSTRUCTIONS

FINAL STEP

SCREW THE 2
WIRES INSIDE
THE CONNECTOR
BOX. LEAVE THE
GREEN WIRE
UNSTRIPPED
AND
UNSCREWED

