

# HARDWIRING INSTRUCTIONS-120V

---

## WALL WIRE

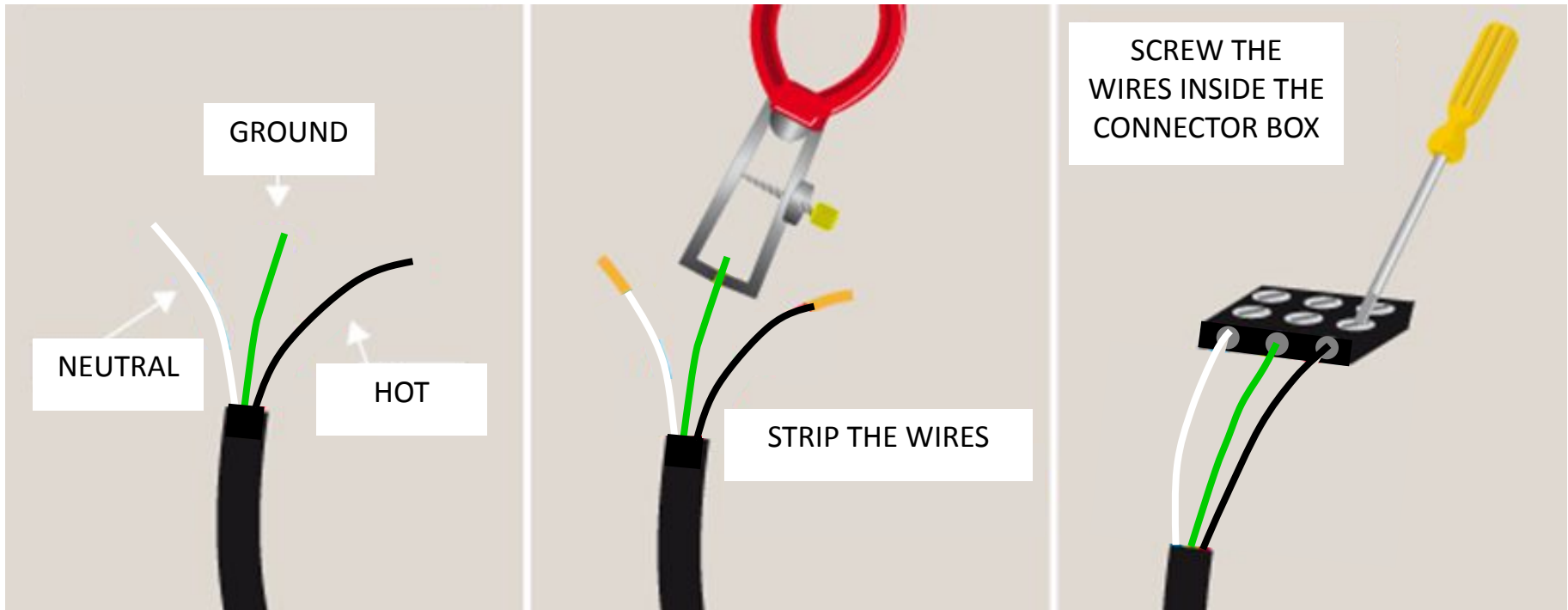

# HARDWIRING INSTRUCTIONS

---

## GLASS HEATER WIRE

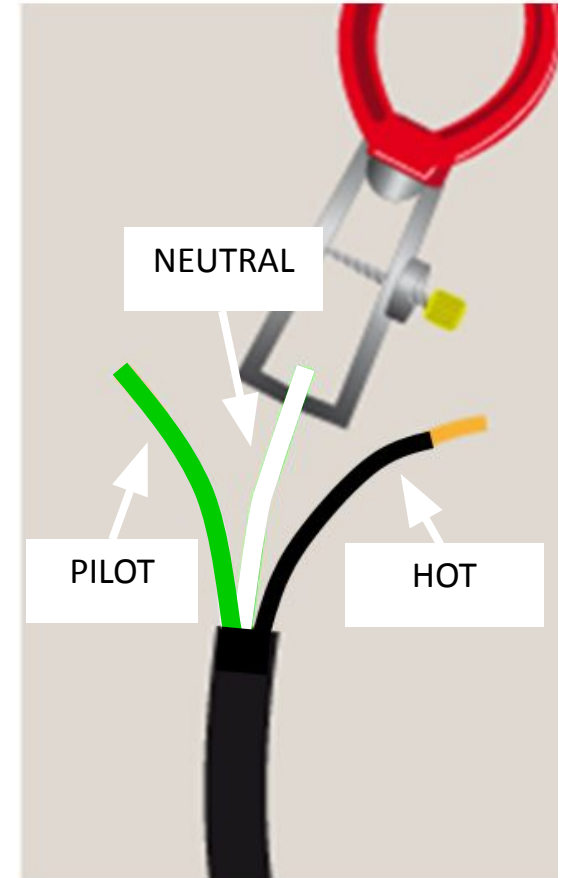
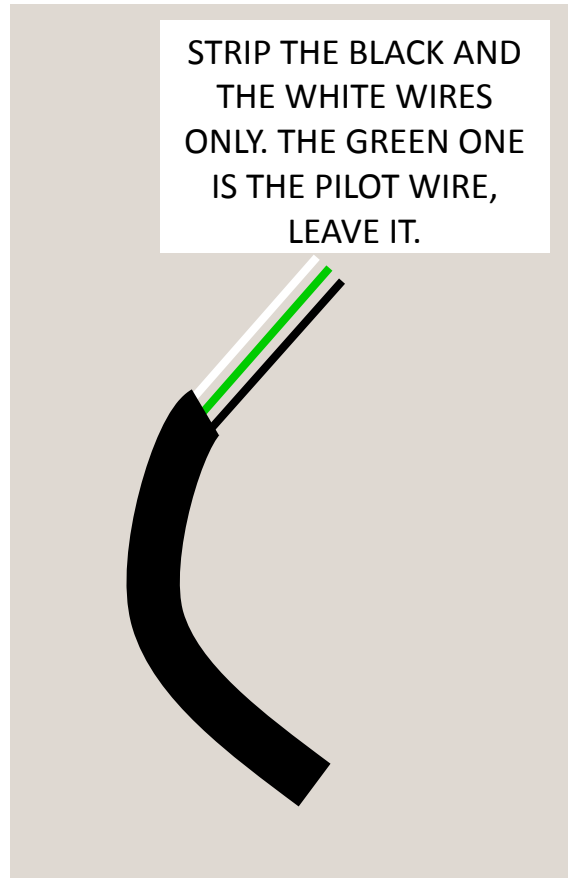
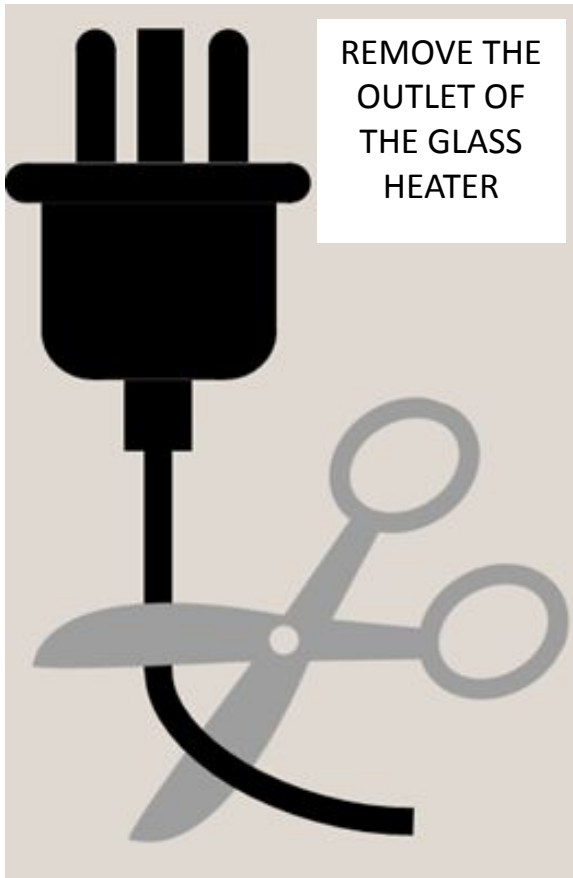

# HARDWIRING INSTRUCTIONS

---

## FINAL STEP

SCREW THE 2  
WIRES INSIDE  
THE CONNECTOR  
BOX. LEAVE THE  
GREEN WIRE  
UNSTRIPPED AND  
UNSCREWED

